

MODEL Z 2680

Standard Run MSRP \$97,176

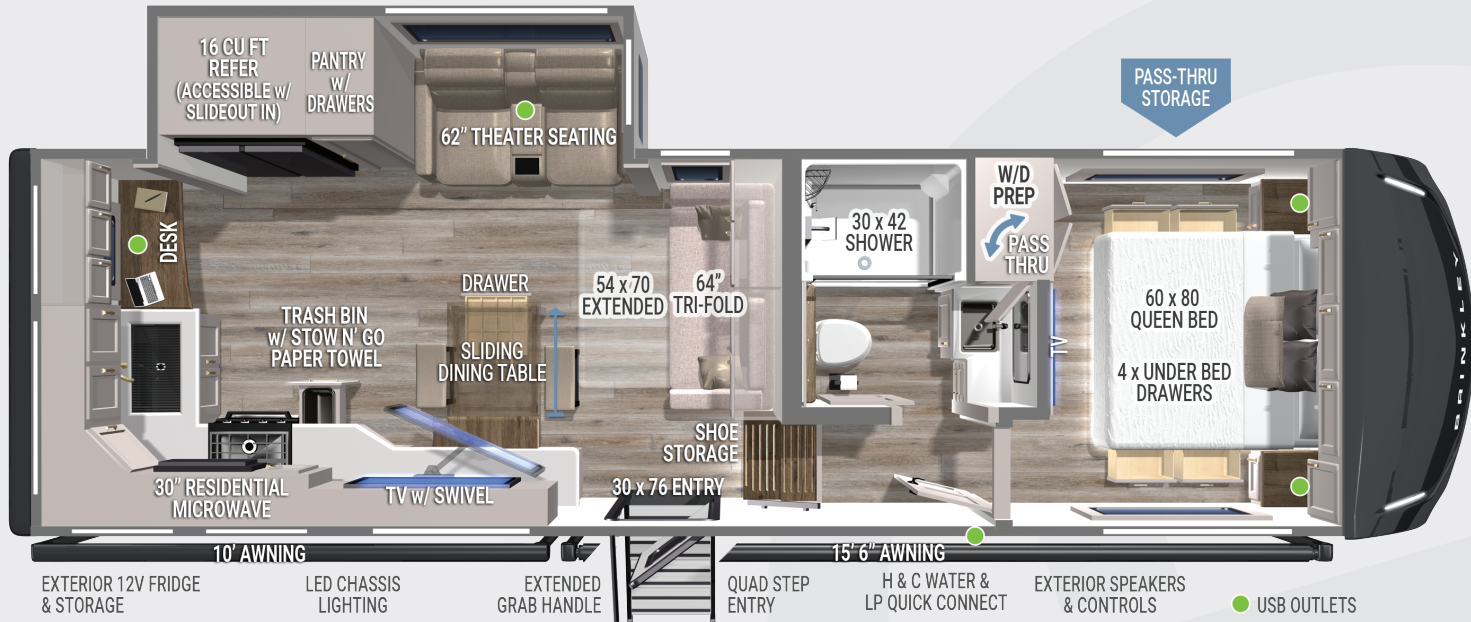

SPECIFICATIONS:

- UVW – 10,978 lbs.
- GVWR – 13,995 lbs.
- Hitch Weight – 1,891 lbs.
- Exterior Length – 29' 11"
- Overall Height w/ AC – 13' 3"
- Width – 96"
- Bath & Bedroom Height - 79 ½"
- Slide Height - 76"
- Wheels & Tires – 17.5" H-Rated
- Fresh Water Capacity – 75 gal
- Gray Water Capacity – True 80+40 gal
- Black Water Capacity – 40 gal
- Insulation – Floors R40, Walls R11, Ceiling R40

FEATURES:

- 64" Trifold Sofa (54"x70" Sleeper)
- Sliding Desk/Dining Table w/ Storage Drawer
- 50" Articulating TV
- Solid Surface Countertops
- Brinkley CraftSense™ Wood Trim Construction
- Premium Residential Cabinets & Drawers w/ Dovetail Joints
- Kitchen & Living Room/Dining Room Flush Floor Slides
- Road Mode: Full Access to Fridge, Bedroom & Bathroom w/ Slide In
- 13.5k Front AC w/ Heat Pump
- Furrion 18k Chill® Cube Rear AC
- Large Pantry w/ Pull-Out Drawers

- One-Piece Fiberglass Shower
- Washer/Dryer Prep (Stackable or Combo)
- Residential Queen Memory Foam Mattress w/ Nightstands, Outlets & USB & USB-C
- 4 Under-Bed Storage Drawers
- Square Euro Frameless Windows w/ 6" Openings
- Integrated Window Screens & Insulated Blackout Blinds (No Valances)
- Brinkley Automotive-Grade Sealant Package
- Automotive Grade Front Cap, Lights, & Lens
- Sleek Styling w/ Automotive-Grade Exterior Graphics
- 2 - Hot/Cold Outdoor Showers (BOTH Sides of Coach)
- Tankless On-Demand Water Heater
- Heated Enclosed Underbelly (Circulated)

- Exterior 12V Refrigerator (3.3 cu. ft.)
- One-Touch Leveling System
- On-Command™ Utility Center w/ Retractable 65' Water Hose
- Industry First Brass Plumbing Connections
- Industry First Low Maintenance Roof
- Heated Tanks w/ Electric Waste Valves w/ Manual-Override
- Heavy-Duty 7k lbs. Axles
- 370W Solar Panel w/ 60AMP MPPT Controller (Inverter Prep & Lithium Ready)

FACTORY OPTIONS:

- Dual Pane Windows \$1,731

111424

